

**R1G250-H056-01B-48**

# DC CENTRIFUGAL FAN

**Diameter: 250mm**



**Shanghai Anneng Fan.Ltd**

Phone: +86 21 62298368

Fax: +86 21 51714668

www.nengfan.com

info@nengfan.com

## Nominal data

Type	R1G250-H056-01B-48	
Motor	AN92DC-N	
Voltage	[VDC]	48
Voltage range	[VDC]	36 .. 57
Speed	[min <sup>-1</sup> ]	2650±5%
Power input	[W]	135±5%
Current draw	[A]	2.81
Perm. amb. Temp.	[°C]	-25~80
Max Perm. Oper. Temp.	[°C]	-20~60

## Parameter

current leakage	<= 0,25 mA
Specification	250mm*56mm
Operation mode	continuous operation S1
Direction of rotation	clockwise, seen on rotor
Mounting position	at will
Insulation class	"B"
Cable exit	any
Bearing	ball bearing (NMB)
Net weight	2.8kg
Surface of rotor	electrophoresis
Operation life	>=40,000 hours
Motor protection	locked-rotor protection, over-current protection
Number of blades	11
Type of protection	IP 44
Protection class	I
Speed control	0-10 VDC / PWM, tach output
Approval	CE

**ANENG**

**Alibaba.com**  
Global trade starts here. 

R1G250-H056-01B-48

# DC CENTRIFUGAL FAN

Diameter 250mm

## Drawing

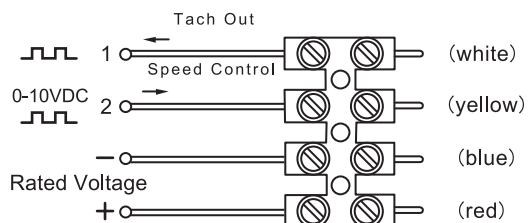
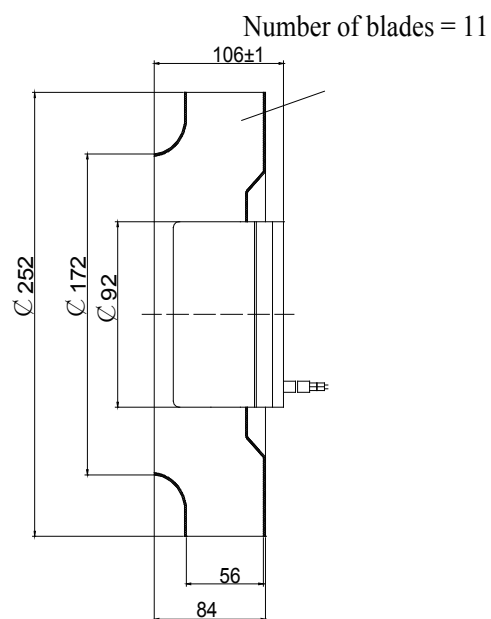
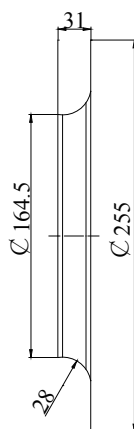
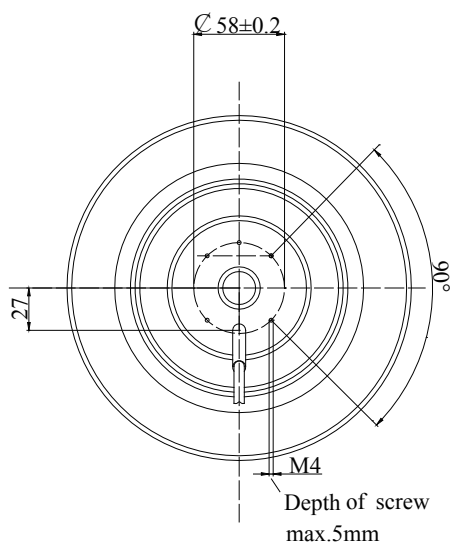

EC motors

Ec motors(nominal24/48 VDC)

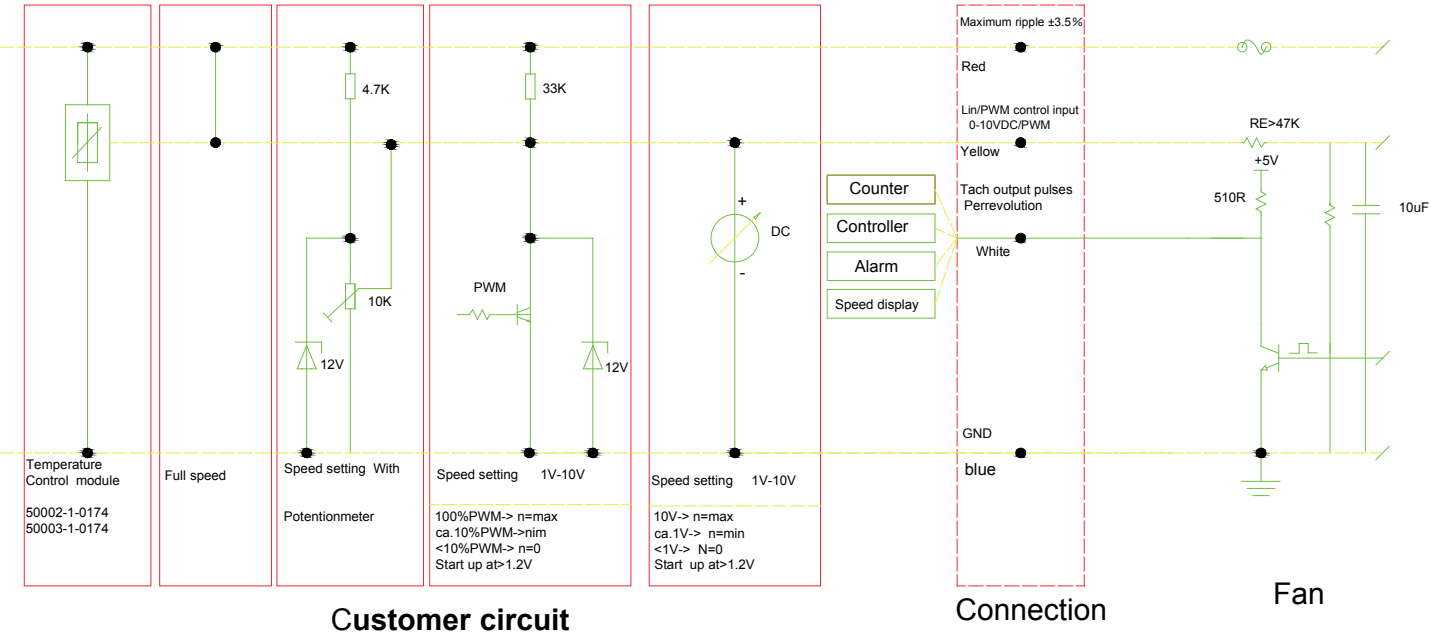

Line	signal	colour	Assignment/function
-	+	red	Maximum ripple $\pm 3.5\%$
	GND	BLUE	GND

Line	Signal	Colour	Assignment/function
1	Tacho	White	Tach output: 2 pulses/revolution for 72mm motor 4 pulses/revolution for 92mm motor
	0-10V/PWM	yellow	Control input (Lmpedance)

Line1

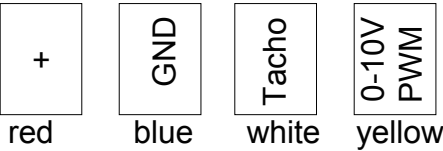

R1G250-H056-01B-48

DC CENTRIFUGAL FAN  
Diameter 250mm

Characteristic

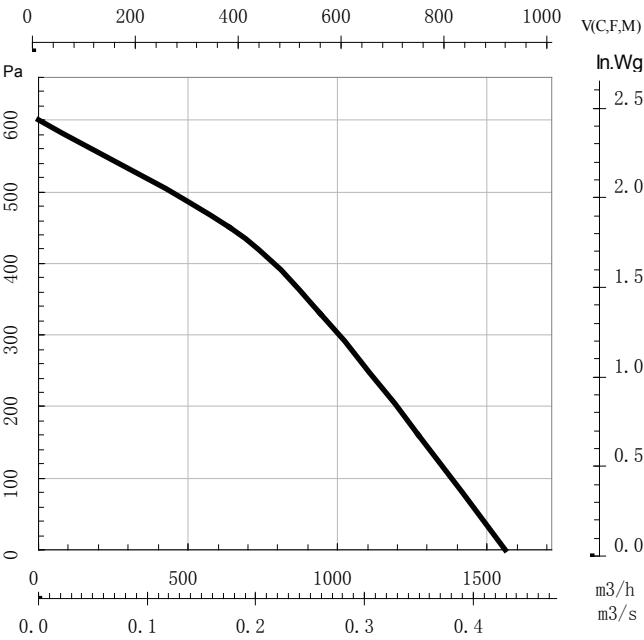

	n [rpm]	P <sub>1</sub> [W]	I [A]	Airflow [m <sup>3</sup> /h]	Pressure st [Pa]
48V	2650	135	2.81	1560	0
48V	2590	168	3.5	1270	160
48V	2570	183	3.81	940	330
48V	2580	178	3.7	640	450
48V	2565	169	3.52	0	600

Note: Testing temperature 21°C  
Atmosphere pressure:1015Hpa

