

### SHEAR DIAGRAM CALCULATIONS

$$F_{gx} + F_{gx} + F_{hx} + F_{Ex} = 0$$

$$-2734.34\# + 3910.01\# + 1885.57\# - 3061.24\# = 0$$

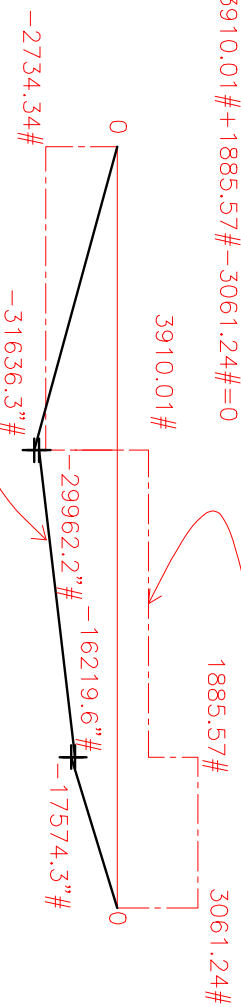

### MOMENT CALCULATIONS

$$M_{1,5700} = -2734.34\# \cdot 11.5700" = -31636.3\#$$

$$M_{1,5700} = -2734.34\# \cdot 11.5700" + (508.986\# \cdot 3.28913") + 3910.01\# \cdot 11.6892" = -16219.6\#$$

$$M_{2,2592} = -2734.34\# \cdot 23.2592" + (508.986\# \cdot 3.28913") + 3910.01\# \cdot 11.6892" = -16219.6\#$$

$$M_{2,2592} = -2734.34\# \cdot 23.2592" + (508.986\# \cdot 3.28913") + 3910.01\# \cdot 11.6892" - (1074.94\# \cdot 1.26030) = -17574.3\#$$

$$M_{9,0000} = -2734.34\# \cdot 29.0000" + (508.986\# \cdot 3.28913") + 3910.01\# \cdot 17.4300" - (1074.94\# \cdot 1.26030) + 1885.57\# \cdot 5.74084" = -.255781\#$$