

Shunt resistors

Ranges 1...2500 A 60/150 mV

4921210042H



Shunts 1...25 A



Shunts >25 A

- *Dimensions to DIN 43703*
- *Class 0.5*
- *Extensive program*
- *Standard versions on stock*

Dimensions

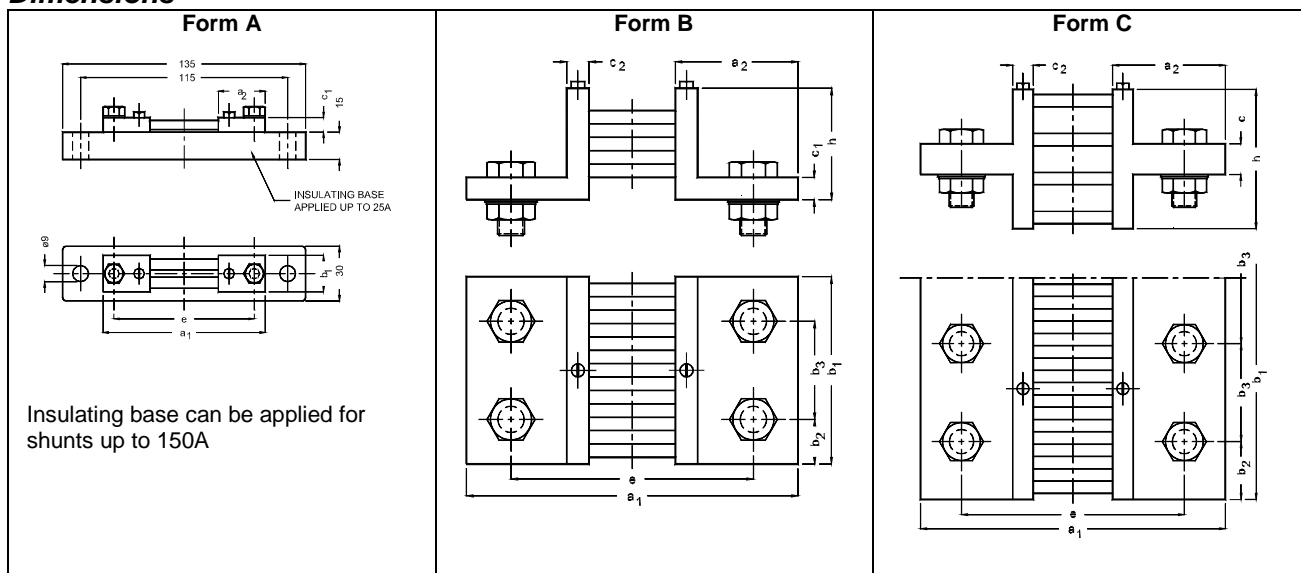

Voltage drop	Dimensions in mm	Amps								
		1-1.5-2.5-4-5-6-8-10-15-25	30-40-50-60-80-100-150	200-250		400-500-600-800	1000	1500	2500	
60mV		Form A		Form B						
	a1	90	100	145			165			
	a2	28	33	55			65			
	b1	20		30	40	60	90	120		
	b2			15	20	30	21	30		
	b3							48	60	
	c1	8		10						
	c2			10						
	e	78	80	105			115			
	h			30						
	Weight kg (max.)	0.12...0.13		0.13	0.61	0.83 0.85 0.9		1.45	1.96	2.9
150mV		Form A		Form B				Form C		
	a1	90	225	270				290		
	a2	26	33	55				65		
	b1	20	25	30	40	70	90	120		
	b2			15	20	35	21	30		
	b3							48	60	
	c1	8		10				15		
	c2			10						
	e	78	205	230				240		
	h			50				60		
	Weight kg (max.)	0.12 0.12...0.13 0.13...0.14	0.16...0.17 0.18...0.20 0.23	0.26...0.68		1.05...1.151.1 1.16...1.30		2.15	3.10	5.20
End block bolts		2 x 1						2 x 2		
Bolt size		M5 x 12	M8 x 15	M12 X 40		M16 x 45		M20 x 50	M16 x 45	M20 x 50
Bolt nut				M12		M16		M20	M16	M20
Voltage screws		5MG X 8CHM with washer								

Accuracy:	Class 0.5 (-10... <u>15...30</u> ...55°C) to IEC 51 and EN 60051.
EMC:	To EN 50081-1/2 and EN 50082-1/2.
	Tightening torque must follow the copper-copper connection in the application.
Temperature coefficient:	0.05%/10°C. The shunt is calibrated at 75% of I_n .
Overloads:	$\leq 250\text{ A } 10 \times I_n$ for 5 sec. $250\text{ A} < \dots \leq 2000\text{ A } 5 \times I_n$ for 5 sec. $> 2000\text{ A } 2 \times I_n$ for 5 sec.

Order specifications

	Shunt resistor	Amps/mV
Example:	Shunt resistor	250 A/60 mV

Due to our continuous development we reserve the right to supply equipment which may vary from the described.



DEIF A/S, Frisenborgvej 33
DK-7800 Skive, Denmark



Tel.: +45 9614 9614, Fax: +45 9614 9615
E-mail: deif@deif.com, URL: www.deif.com

